



BACKUP BATTERY INSTALLATION GUIDE

The Backup Battery provides up to 48 hours of operation if power is interrupted. Estimated operation time is based on 10 cleaning cycles per day (which is typical of two cats), but results will vary.

When power is interrupted, the unit will automatically switch to battery power and a yellow light will illuminate the Power button on the Control Panel. To conserve energy, the Night Light will not function. The Litter-Robot will switch back to household power when it returns, and the unit will begin recharging the battery.

Backup Battery Kits can be ordered at www.litter-robot.com.

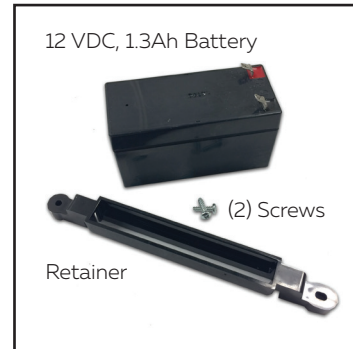

INSTALLATION

1. Press the Power button to turn the unit off, then unplug the unit.
2. Remove the Bonnet and Globe.
For complete instructions, see the Manual or visit <https://www.litter-robot.com/owners-manual.html>.
3. Pull out the Waste Drawer and locate the silver sticker on the back wall of the Base. Note your unit's serial number.
4. Gently turn the unit over to access the battery pocket on the underside of the Base.
5. According to the serial number, connect the battery leads as follows:
Serial numbers 934 and above:
Connect the RED lead to the RED terminal.
Connect the BLACK lead to the BLACK terminal.
Serial numbers 0-933:
Connect the RED lead to the BLACK terminal.
Connect the BLACK lead to the RED terminal.
6. Insert the battery into the pocket, so the connected side goes into the Base first.
7. Align the Retainer across the bottom of the battery and attach using screws provided.
8. Reassemble the Waste Drawer, Globe, and Bonnet, then plug the unit in and turn it on.

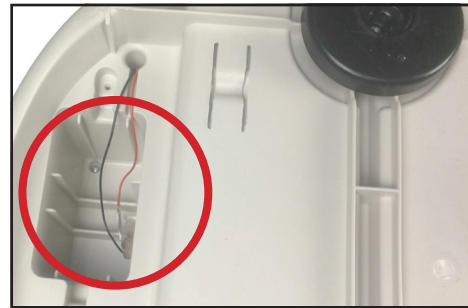

Visit www.litter-robot.com for installation videos.

