



MOTOR ASSEMBLY INSTALLATION GUIDE

You will need:

- 8-inch #2 Phillips screwdriver
- Needle-nose pliers

For installation videos, visit the Customer Service playlist at www.youtube.com/user/TheLitterRobot or scan the QR code above.



Motor Assembly

PREPARATION

1. Press the Power button to turn the unit off and unplug it from the wall.

Remove the Bonnet, Globe, and Waste Drawer. For detailed instructions, visit <https://www.litter-robot.com/owners-manual.html>.

2. The plastic component that covers the Control Panel on the Base is called the Bezel. Unscrew the 5 screws to remove the Bezel.



Figure 1

3. Use needle-nose pliers to lift the Bezel out of place.



Figure 2

4. Separate the Bezel from the Control Panel by pushing the buttons through and lifting up. Set the Bezel and screws aside.

Note: The Circuit Board and Keypad may be held in place by a piece of tape (assembly aid). If present, simply remove it; it is not required for reassembly.

Let the Keypad and Circuit Board hang gently; you do not have to disconnect any wires from it.



Figure 3



REMOVE OLD MOTOR ASSEMBLY

5. In front of the black gear, locate the red and white wires and use the needle-nose pliers to lift them out of the wire channel.



Figure 4

6. With your fingers, separate the two wire connectors: white from brown; red from green.



Figure 5

7. Free the Motor wires by peeling back the piece of tape that holds the wires in the channel and out of the way of the Motor.

Note: It is best to reuse the tape. If the tape cannot be reused, replace it with a piece of stretchable tape that adheres strongly to the Base to ensure it will remain in place over time. We recommend Scotch 8884 Stretchable tape or something similar.

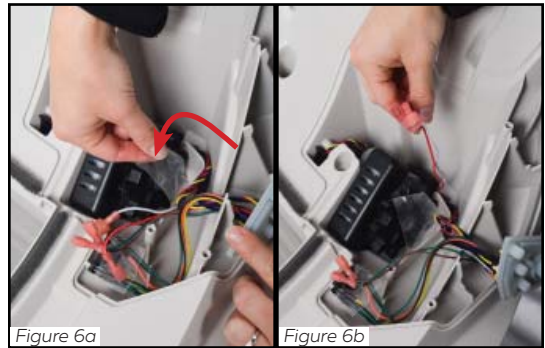

Figure 6a

Figure 6b

8. Lift the Motor Assembly out of the cavity and remove the two black Motor gloves, noting from which sides you are removing them.

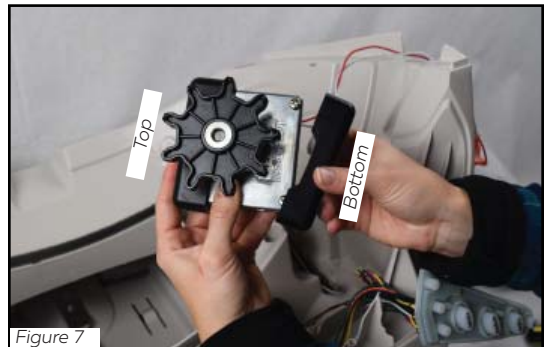
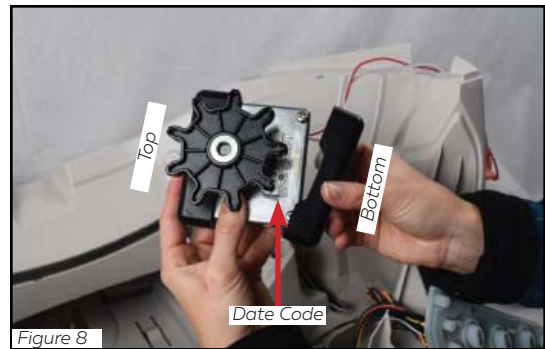

Figure 7

INSTALL NEW MOTOR ASSEMBLY

- Fit the two Motor gloves from the old Motor onto the new Motor. Fit them onto the top and bottom as shown in *Figure 8*.

Note: The date code should be at the bottom, facing toward the front.



- Hold the Motor in your left hand and with your right, pull the red and white wires taut against the bottom of the Motor.

Lower the Motor into the cavity, ensuring the red and white wires are positioned below it in the wire channel.

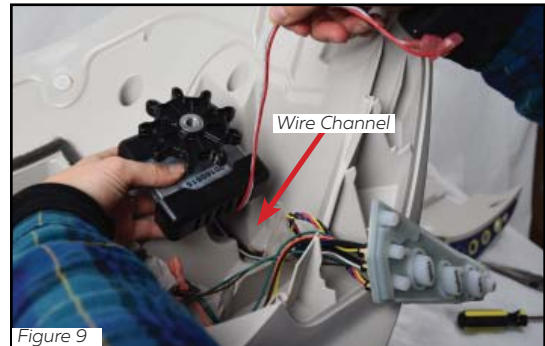

- Check that no wires in front of the Motor are in the way of the black Gear.

Tuck the Motor wires in the wire channel that runs in front of the Motor and secure them with the tape. Make sure everything lays flat in the channel.

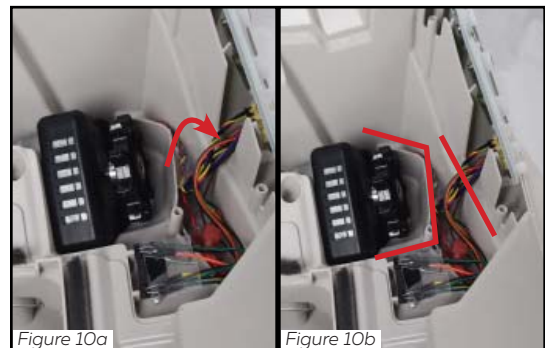

- Reconnect the Motor wires.

Connect the red wire to the green wire and the white wire to the brown wire.



- Tuck the two wire connectors in the wire channel to the left, so they are out of the way of the Motor and Gear.



REASSEMBLY

14. Make sure the wires attached to the Circuit Board are tucked behind it in the wire channel.



Figure 13

15. Reassemble the Bezel onto the Circuit Board and Keypad by holding the Circuit Board upright and fitting the Bezel over it, so the buttons come through the Control Panel.

Make sure to keep the Keypad wrapped around the edges of the Circuit Board.



Figure 14

16. Make sure the edges of the Bezel rest flush with the Base.

Once in place, look through the opening where the black Gear protrudes and make sure no wires are visible. If wires are visible, remove the Bezel, tuck them into the wire channel, and secure them with stretchable tape.



Figure 15

17. Attach the Bezel by tightening the 5 screws. Do not overtighten.

18. Reassemble the Globe, Bonnet, and Waste Drawer. Plug the unit in, turn it on, and let the initial Clean cycle finish. The Globe should return to the Home position with the blue Ready light on.

If your unit does not cycle or does not cycle properly, review your installation.

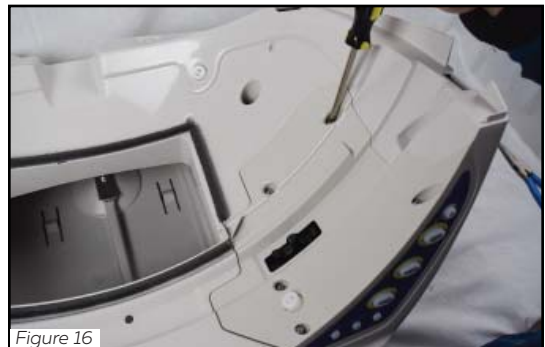

Figure 16

