

Installing Litter-Robot 4 Upper Waste Port Seal Strips

Add seal strips to the upper waste port to help reduce odors.

What you will need:



Putty knife or flathead screwdriver (optional)



Gorilla Tape or other duct tape



Rubbing alcohol

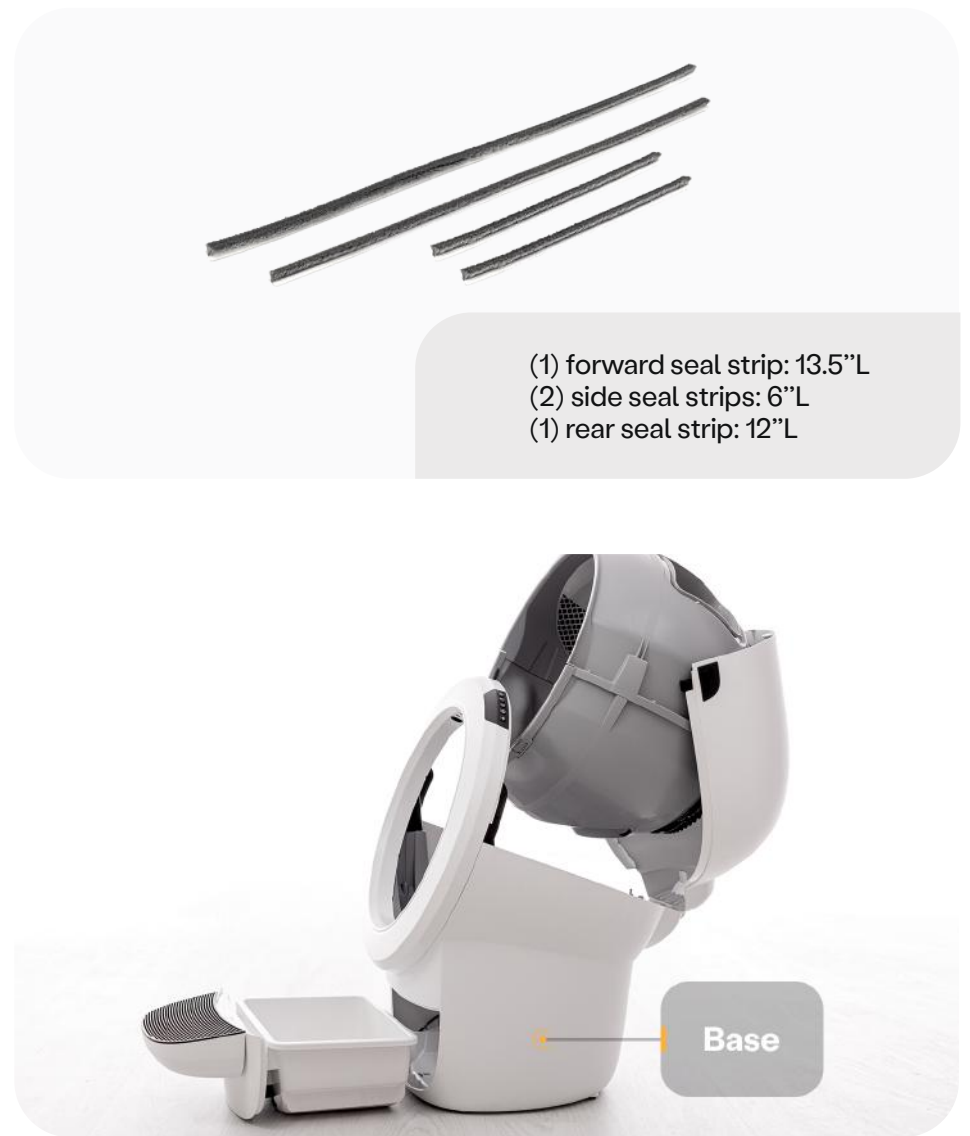

- (1) forward seal strip: 13.5"L
- (2) side seal strips: 6"L
- (1) rear seal strip: 12"L

How to install



1

- ✔ Make sure the unit is in the Home/Ready position. Press the Power button to turn the unit off, then unplug the unit.



2

- ✔ Open the bonnet: Press and hold the latches on both sides of the bonnet, then lift and rotate the bonnet to its open position.



3

- ✔ Remove the globe: Grab the black handle located on top of the globe, lift the globe off the base, and set it on the floor.

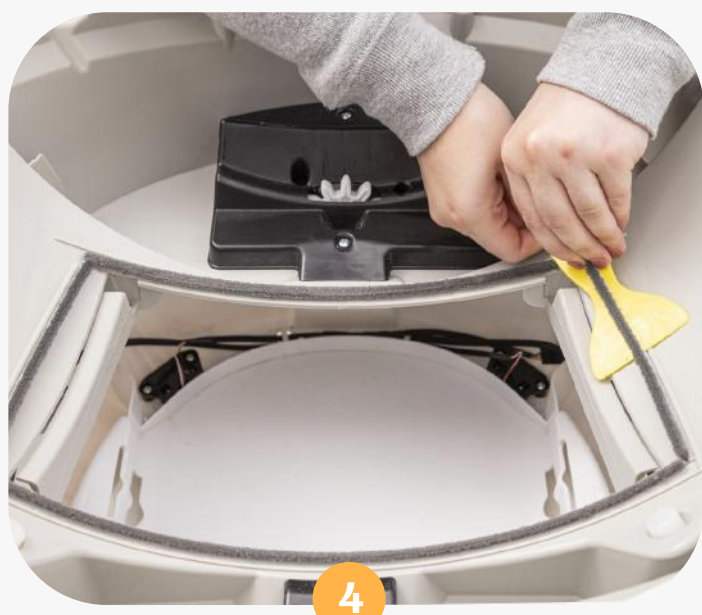

4

- ✔ Locate the old upper waste port seal strips in the base. Use a putty knife, flathead screwdriver, or your fingernail to lift the corner of a strip and peel off all four (4) strips.



5

- ✔ To ensure that the new seal strips adhere to the base, remove any litter and old strip residue. This can be done with some 3/8 inch strips of Gorilla Tape or another type of sturdy duct tape. Apply tape to residue, rub to adhere firmly, and pull off. Repeat around the port. Clean any residue left behind with rubbing alcohol.



6

- ✔ Replace the forward seal strip first, which is 13.5"L. Peel off the adhesive backing on the strip and place it along the inside of the strip guideline. Run your finger along the strip a few times to ensure adhesion.



7

- ✔ Next, replace the (2) side seal strips, which are 6"L. Place immediately adjacent to the forward seal strip, and along the inside of the strip guideline.



8

- ✔ Finally, replace the rear seal strip, which is 12"L.



9

- ✔ Replace the globe: Hold the globe by the handle and slide it back into the base. Ensure the back of the globe is sitting flush in the rear bearing pocket. The large black gear on the rear of the globe will line up with the small white gear in the base.



10

- ✔ Close the bonnet: Rotate the bonnet downward over the globe and push down on the bonnet from the top to make sure it is latched and secure.

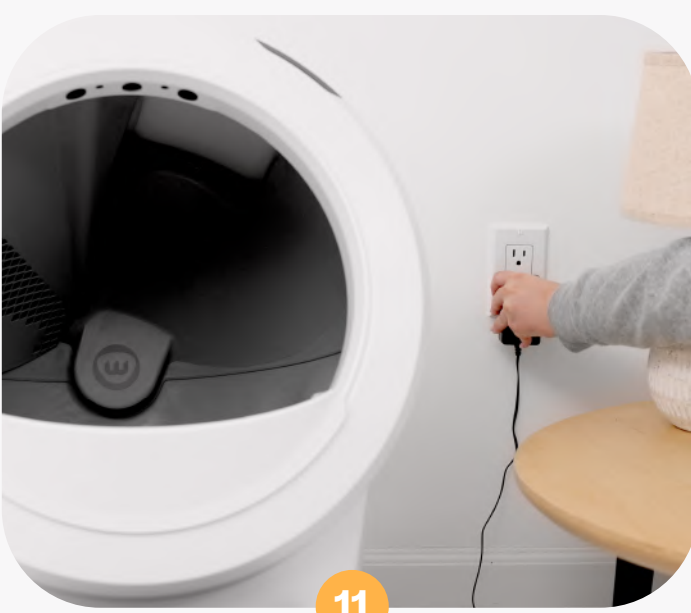

11

- ✔ Plug the unit back in and power it on.



12

- ✔ Observe two clean cycles to ensure the new seal strips don't get pulled up. Watch as the dump port rotates over the waste port area—if the seals are not adhered well enough, they could get pulled up by the rotating globe and cause an over-torque fault or a globe position fault. Reference [this video](#) for further information.